



POWERED BY NATURE

The Salmo Craft Co. | Model HB1

The Salmo Craft Co. was established in 2023 with a mission to create better outdoor experiences through innovation, design, and craftsmanship.

Our team set out to rethink the houseboat with modern design, sophisticated minimalism, and sustainable innovation as our signposts. The Model HB1 is the result.

Our next-generation houseboat is powered by the clean, sustainable energy of the sun, designed for complete self-sufficiency, beautifully crafted, and finely appointed.



State-of-the-art solar system

Latest made-in-Canada bi-facial panel technology. Large made-in-Canada lithium-Ion battery pack. Propane-powered backup DC generator. Level 2 EV charging capacity.

Craftsmanship and material choices

High-quality materials and attention to detail throughout.

Nordic-inspired design and architecture

Rugged, refined, unique. A new take on houseboat aesthetic aimed at the modern adventurer.

Electric propulsion system

Zero-emissions, quiet and maintenance free. Unlimited range. A vastly improved boating experience.

Innovative water and septic management systems

Designed for complete off-grid self-sufficiency. No need for on-shore power, fill-ups or pump-outs.

Custom-built aluminium hull and house frame

Top-quality construction, built in Canada to last a lifetime. Mechanical and storage solutions under deck.

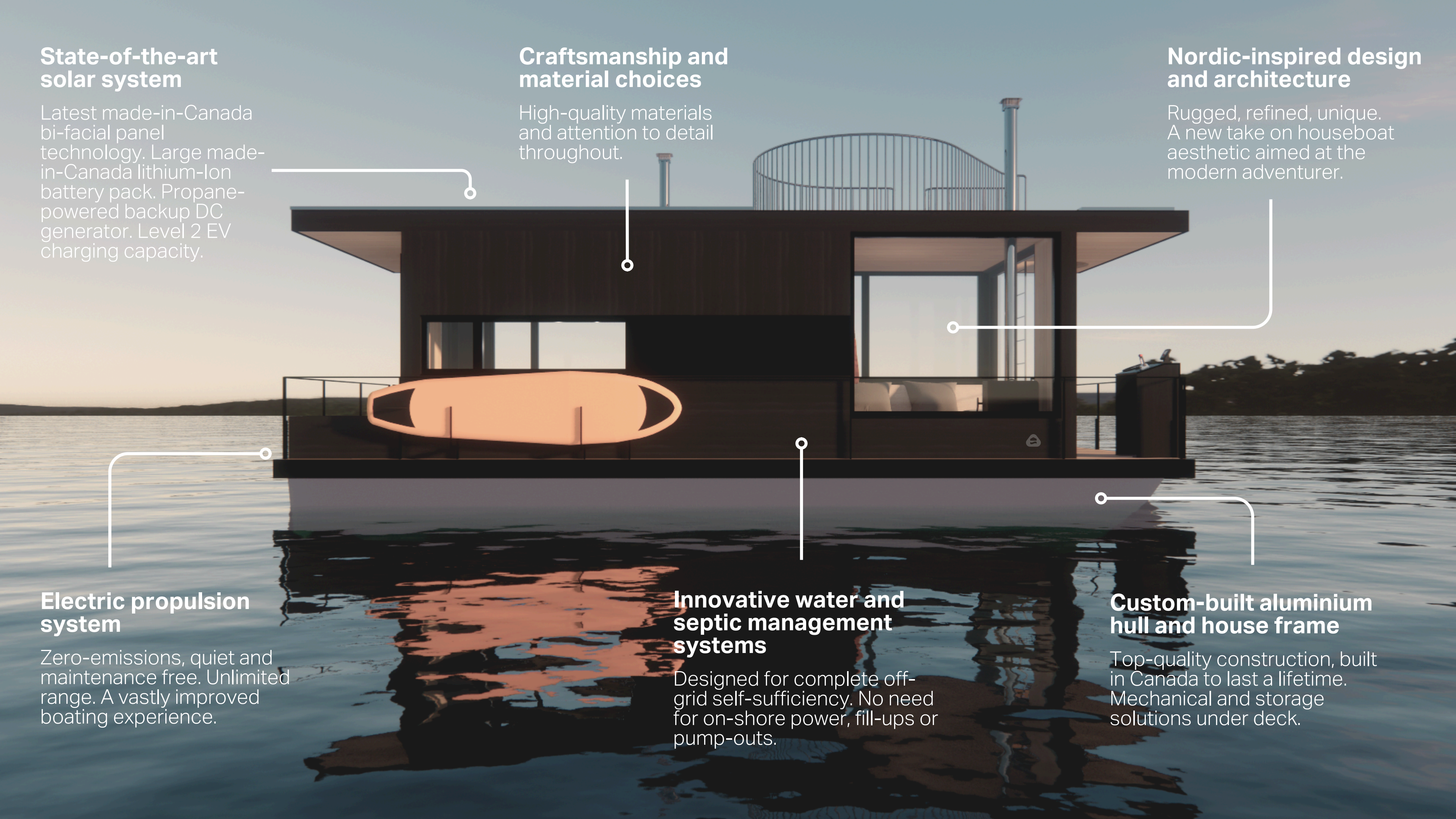

Model HB1 | Specifications

DIMENSIONS

LOA: 32'
Beam: 12'
Weight: 12,000 lbs
Interior space: 280 sq feet
Fore deck: 48 sq feet
Aft deck: 54 sq feet
Rooftop terrace: 70 sq feet

POWER SYSTEM

Solar Panels: 10 x 340 kW
35 kWh battery pack (with room for expansion)
8kw inverter
Level 2 shore power charging port
Back up 3kw DC generator
100 Amp panel for house loads
2 x 100 lb LPG tanks

PROPULSION SYSTEM

2 x Elco EP-20 (equivalent to 40HP)
Hydraulic steering system
Electric tilt
Max speed: 7 knots (13 km/h)

TECHNOLOGY

Touchscreen helm console, navigation & depth

AMENITIES

Custom kitchen by Jarico Design

Full-size DC solar fridge
Propane cooktop
Fan hood
Large double sink
Convection toaster oven

Full-size bathroom

Shower
Sink and vanity
Incinerating toilet by Cinderella
Ceiling exhaust fan

Sleeping/living/dining

Banquette dining table converts to queen bed
Elevator queen bed above dining
Queen size sofa bed
Pocket doors to provide privacy to front and back rooms
Tent anchoring points on rooftop

Heating

Propane stove by Jotul - 24,000 BTUs

FINISHES

Aluminum windows and doors throughout

Interior

Rubber flooring by Mondo
Lighting design by Flux Lighting
Customizable interior panelling

Exterior

Marine cork decking by SeaCork
Customizable exterior siding

RIGGING

7' stowable aluminum boarding ramp
Electric windlass anchor
Telescopic swimming ladder
Rub rails
LED navigation lights
Underwater lighting



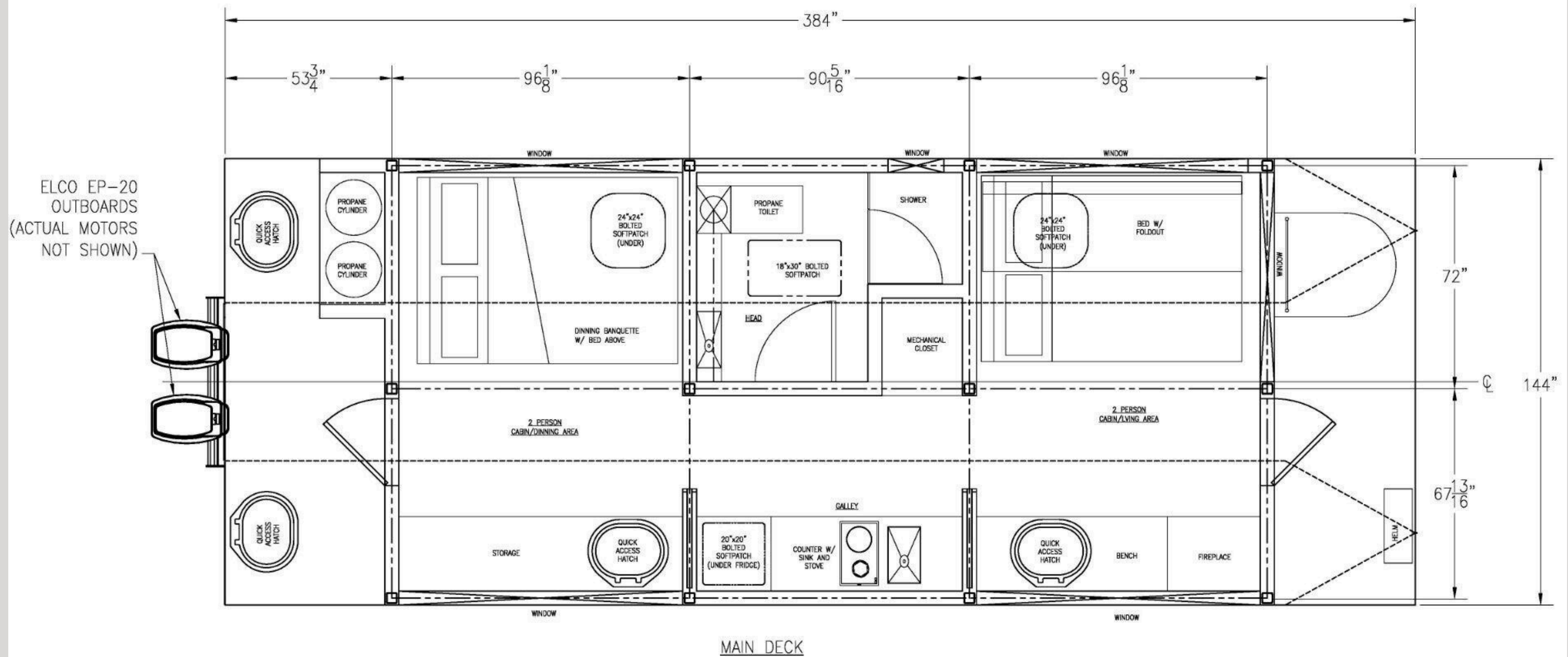

ELCO EP-20
OUTBOARDS
(ACTUAL MOTORS
NOT SHOWN)

M O D E L H B 1
Floorplan

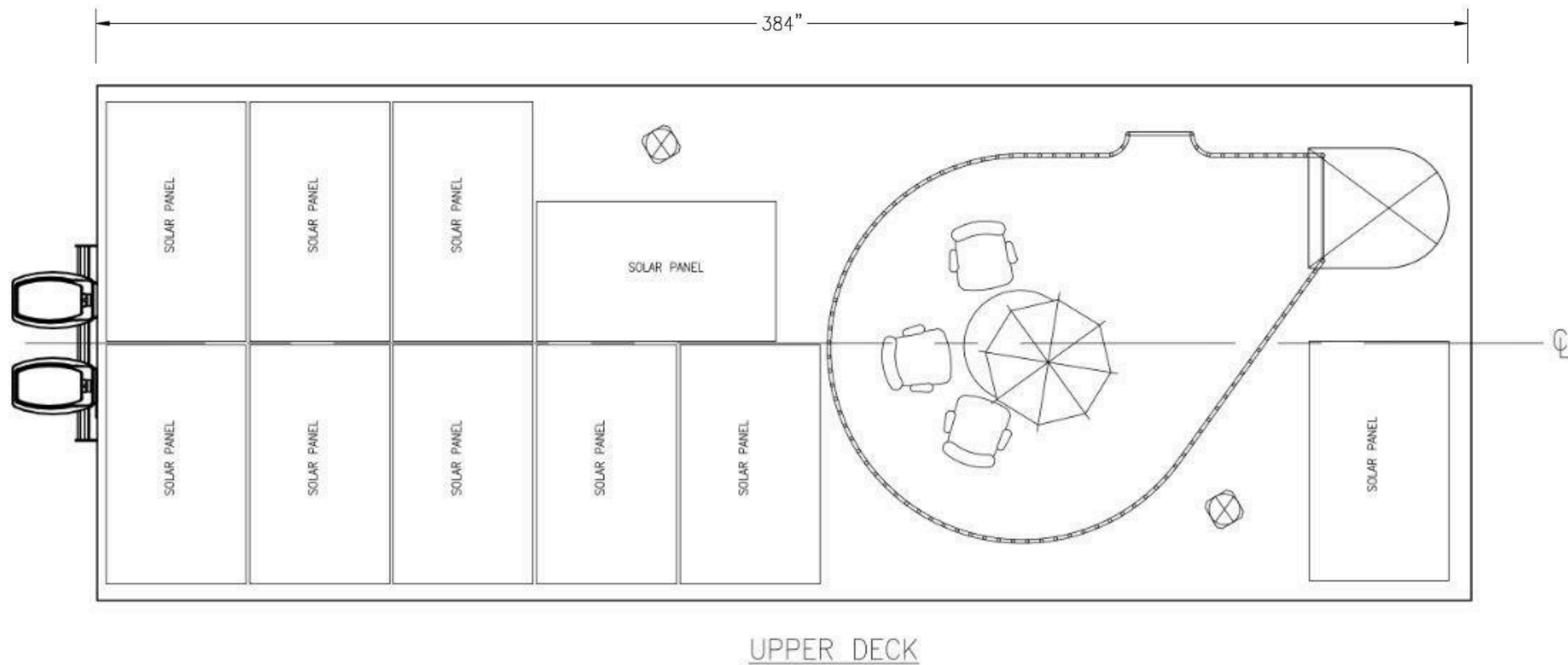

MODEL HB1
Floorplan

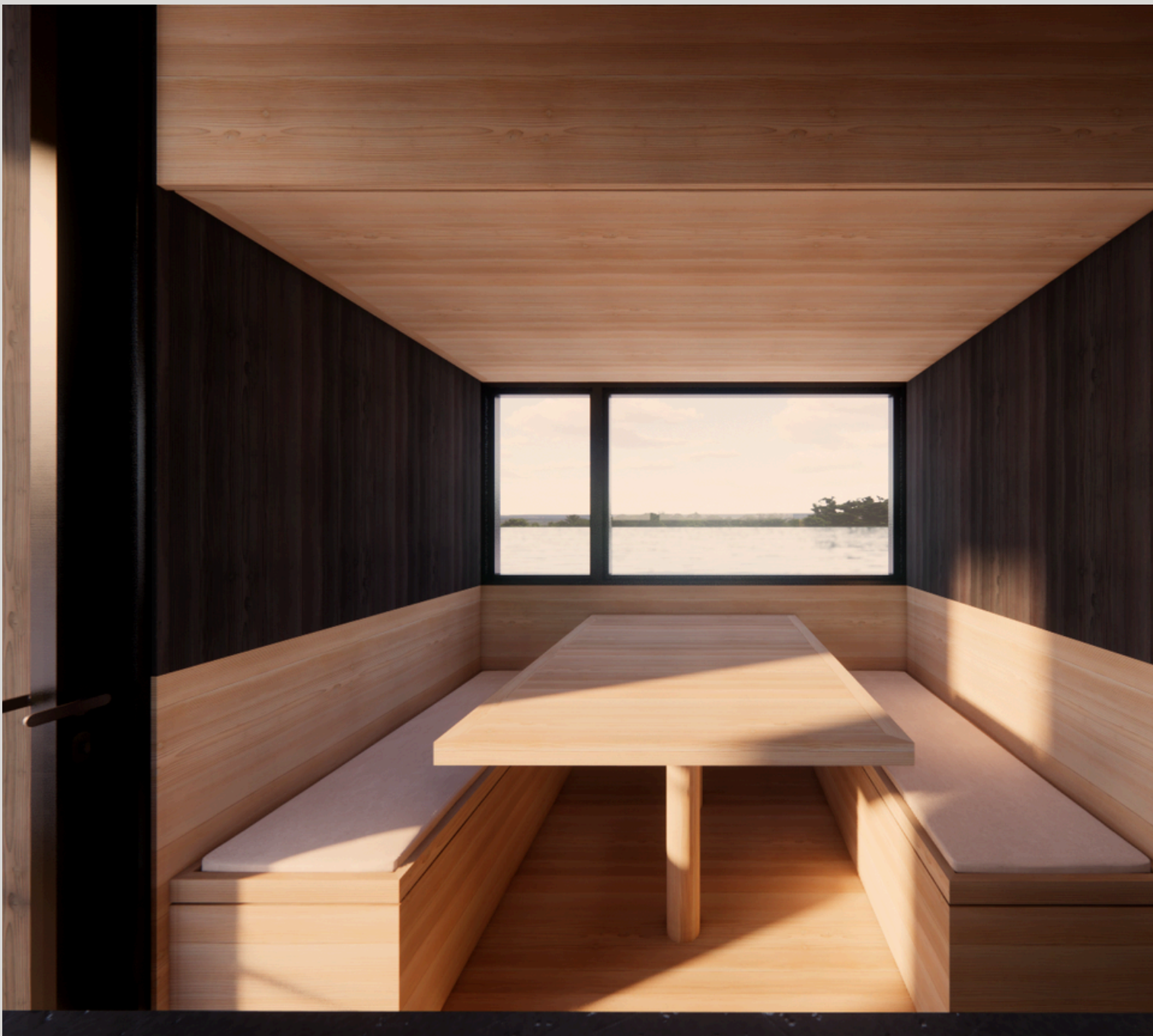

M O D E L H B 1
Interior perspectives



hello@salmocraft.com
613.296.1057
salmocraft.com